

HUNTERS®

HERE TO GET *you* THERE

64 Dovedale Road, Wolverhampton, West Midlands, WV4 6RA

Offers In The Region Of £260,000

Property Images



HUNTERS[®]

HERE TO GET *you* THERE

Property Images



Floorplan

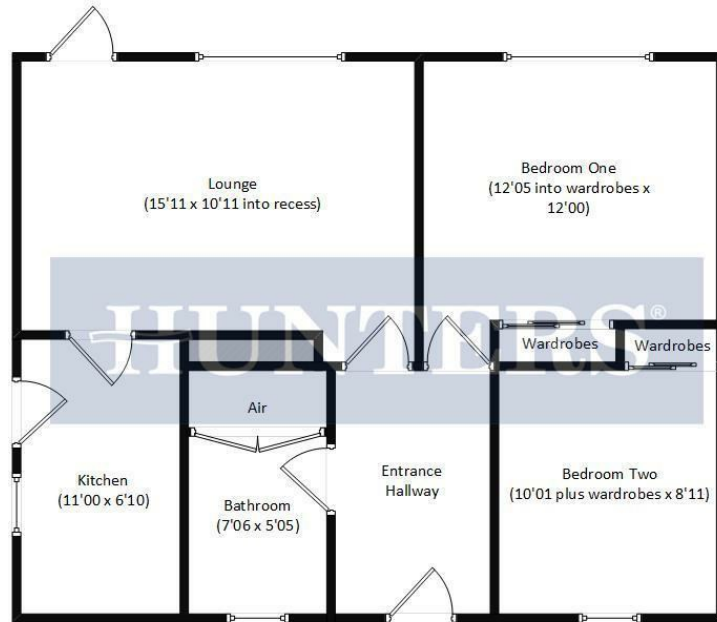

This floorplan is for illustrative purposes only and all measurements are approximate and not drawn to scale.

EPC

Energy Efficiency Rating		
	Current	Potential
Very energy efficient - lower running costs		
(92 plus) A	64	85
(81-91) B		
(69-80) C		
(55-68) D		
(39-54) E		
(21-38) F		
(1-20) G		
Not energy efficient - higher running costs		
England & Wales		EU Directive 2002/91/EC 

Map



Details

Type: Bungalow - Semi Detached Beds: 2 Bathrooms: 1 Receptions: 1 Tenure: Freehold

Summary

Hunters are pleased to present this semi detached bungalow being sold with no upward chain. Well maintained throughout and occupying a sizeable plot on the ever popular Dovedale Road, this property promises to be an ideal choice for those looking to downsize.

Offering convenient living across one floor, the internal accommodation is to briefly comprise of an entrance hall, two good sized bedrooms, house bathroom, lounge and fitted kitchen with side access.

To the fore is generous off road parking and access to garage ideal for storage solutions. Whilst a beautiful rear garden provides the idyllic retreat for enjoying summer days.

Viewing is highly recommended to appreciate this brilliant bungalow. To arrange a viewing please call the office.

Features

• SEMI-DETACHED BUNGALOW • TWO BEDROOMS • WELL MAINTAINED THROUGHOUT • NO UPWARD CHAIN • IDEAL FOR DOWNSIZERS • SIZEABLE PLOT • GARAGE & GENEROUS OFF ROAD PARKING • BEAUTIFUL REAR GARDEN • POPULAR DOVEDALE LOCATION • PLEASE CALL 01902 672 274 TO BOOK A VIEWING!